

Frame Size N (1000-1250) Amperes

1



Product description:

Complying to IEC 60947-2,
 Maximum continuous Ampere rating at 40°C Voltage 240/415V,
 Frequency 50/60Hz

Ue Maximum	415V
Icu	70 kA
Ics	50 kA
Ui	1000V
Uimp	12kV

Dimension:	H	W	D	Weight Kgs.
3Pole	406	210	140	21.3
4Pole		280		28.3

Marking

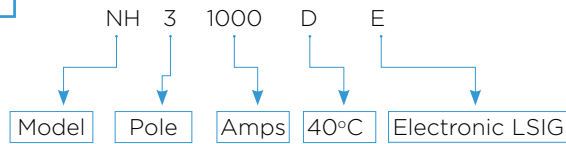

 70/50 kA	NH - Frame MCCB 70/50kA AT 415V (Adjustable - LSIG) 40°C				
	In (A)	3 pole		4 pole	
		Cat. No.	Ref.No.	Cat. No.	Ref.No.
1000A	NH31000ED	W612818	NH41000ED	W612820	
1250A	NH31250ED	W612819	NH41250ED	W612821	

	NHY - Frame MCCB (Non-Automatic) 40°C (IEC 60947-3)				
	In (A)	3 pole		4 pole	
		Cat. No.	Ref.No.	Cat. No.	Ref.No.
1000A	NHY31000D	W612822	NHY41000D	W612824	
1250A	NHY31250D	W612823	NHY41250D	W612825	

Frame Size N (1000-1250) Amperes

Drawing

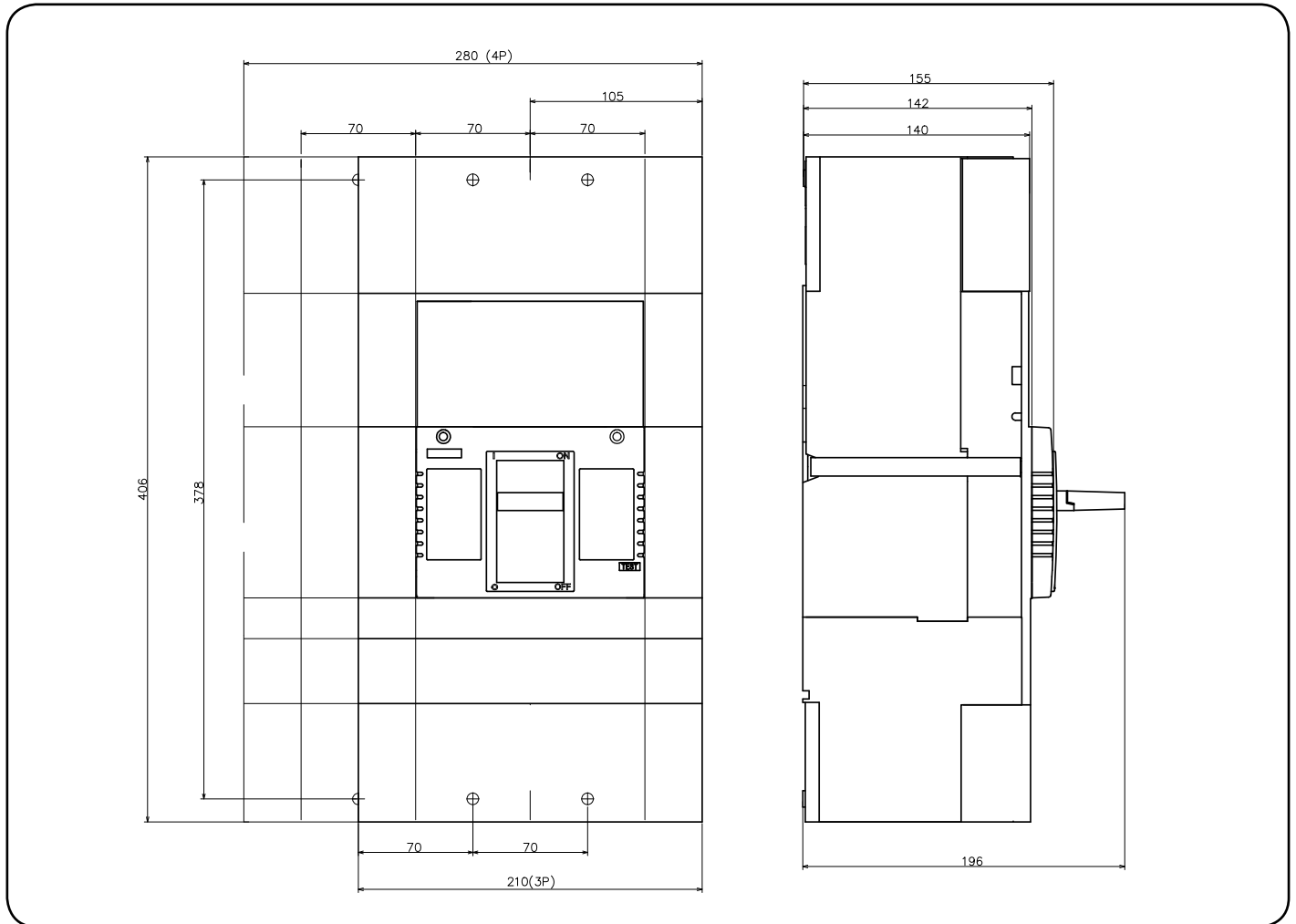

1

Moulded Case Circuit Breakers